



DW 82 INOX

Frigo vini ventilato / Ventilated wine cooler



Capienza / Capacity

DW 82 INOX

Bottiglia cl. 75 / Bottle cl. 75

45

Dati indicativi e variabili a seconda dei diversi packaging / Variable data depending on the different packaging



Bordolese

Alsaziana

Borgognotta

Rhône



Cassetti in acciaio (DW 82 INOX)
Stainless steel drawers (DW 82 INOX)

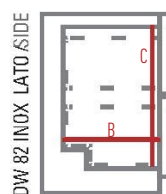
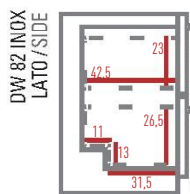
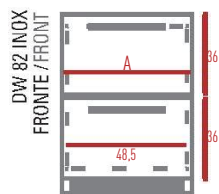

Dimensioni mm / Dimensions mm	DW 82 INOX
Dimensioni Esterne (LxPxH) / External Dimensions (WxDxH)	595 x 580 x 820
Dimensioni Imballo (LxPxH) / Packaging Dimensions (WxDxH)	660 x 625 x 1001
A - Larghezza / Width	510
B - Profondità / Depth	430
C - Altezza / Height	650
D - Profondità Min. / Min. Depth	-
E - Altezza Min. / Min. Height	-
Adesivo Laterale / Side Sticker	-
Adesivo Vetro / Glass Sticker	-

Caratteristiche Tecniche / Technical Features	DW 82 INOX
Temperatura / Temperature Range	+2 °C / +10 °C
Classe Climatica / Climate Class	4
Volume Netto-Lordo / Net-Gross Volume	Lt. 137 / 145
Superficie Esterna Body	Lamiera preverniciata con trattamento anticorrosione Prepainted sheet with anticorrosion treatment
Porta Door	Cassetti in acciaio INOX 304 INOX 304 stainless steel drawers
Superficie Interna / Inner Liner	ABS
Termostato Thermostat	Elettronico / Electronic
Rumorosità / Noise level	dB 52
Spessore isolamento / Insulation thickness	mm 45
Sbrinamento Defrost	Automatico a fermo compressore Automatic compressor cycle
Illuminazione / Lighting	2 led verticali / 2 vertical led
Chiave e serratura / Lock and key	-
Reversibilità porta / Reversible door	-
Mensole in legno ad estrazione a cassetto (LxP) Removable wooden shelves (WxD)	2 Cassetti in acciaio INOX 304 2 INOX 304 stainless steel drawers
Ruote-Piedi / Castors-Feet	4 Piedi / 4 Feet
Peso Netto-Lordo / Net-Gross Weight	Kg 48 / 52
Voltaggio / Voltage	V 220
Frequenza / Frequency	Hz 50
Refrigerante / Refrigerant	R600A
Assorbimento / Absorption	W 100
Consumo Energia / Energy Consumption	Kwh/24H 0,39